

UNIFLEX RBCF

RESIN BONDED CORK FILLER



UNIFLEX RBCF

RESIN BONDED CORK FILLER

PRODUCT FEATURES

UNIFLEX RBCF is a resin bonded cork expansion joint fillers, it is manufactured from granulated cork bound together with a synthetic resin and highly suitable as a filler board support for joint sealants for use in movement joints.

UNIFLEX RBCF does not contain bitumen or tar and cannot impair the adhesion of any joint sealing compound by contaminating the joint faces. When subjected to wet or moist conditions, it is capable of swelling to occupy a larger volume than that of the material as supplied.

UNIFLEX RBCF is suitable for use in all types of concrete construction. It is particularly recommended for use in water retaining structures where it is essential that joints remain tightly packed even if they increase in width.

ADVANTAGES

- Simple and Easy To Handle and Install
- Will not Extrude under Compression
- Resilient / Non-tainting / Rot proof
- Low Load Transfer Across an Expansion Joint

FIELD OF APPLICATION

Water Tanks	Driveways
Ideal for Wet Areas	Highways and Bridges
Water Treatment Plants	Airport Runways
Dams	Pedestrian Malls
Sewage Treatment Plants	Footpaths
Reservoirs	Brick or Block Walls
Swimming Pools	Abutments & Parapet Walls

TECHNICAL PROPERTIES

PROPERTY	UNIT MEASUREMENT	RESULTS
Apparent Density	kg/cm ³	210
Solid Content	%	100
Compression to 50% of original thickness - Stress applied	N/mm ²	0.54
Recovery after compression test	%	> 96
Weathering Test		No disintegration

PHYSICAL PROPERTIES

MATERIAL	Granulated cork bound with resin
COLOUR	Brown
STORAGE	Store in dry condition
SIZE	915mm x 610mm
THICKNESS	10mm, 12mm, 20mm, 25mm
PACKING	10mm : 30 sheets / carton 12mm : 25 sheets / carton 20mm : 15 sheets / carton 25mm : 12 sheets / carton

TYPICAL APPLICATIONS

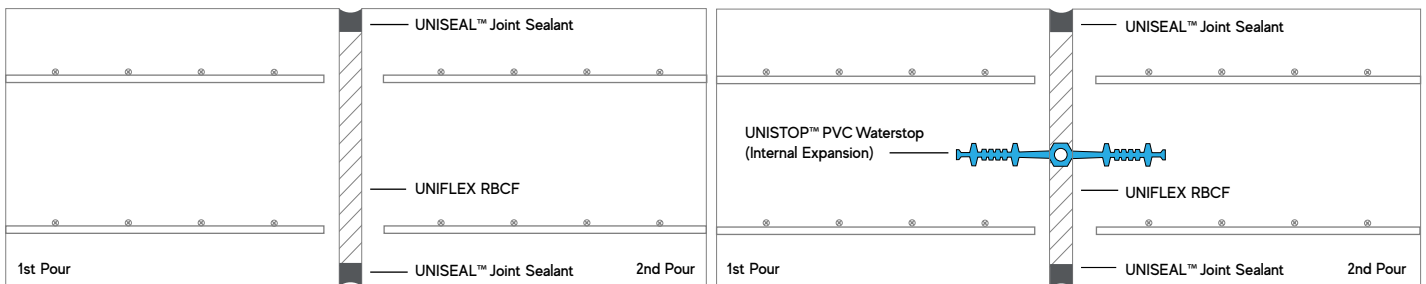

STANDARD DETAILS OF WALL / SUSPENDED SLAB APPLICATIONS

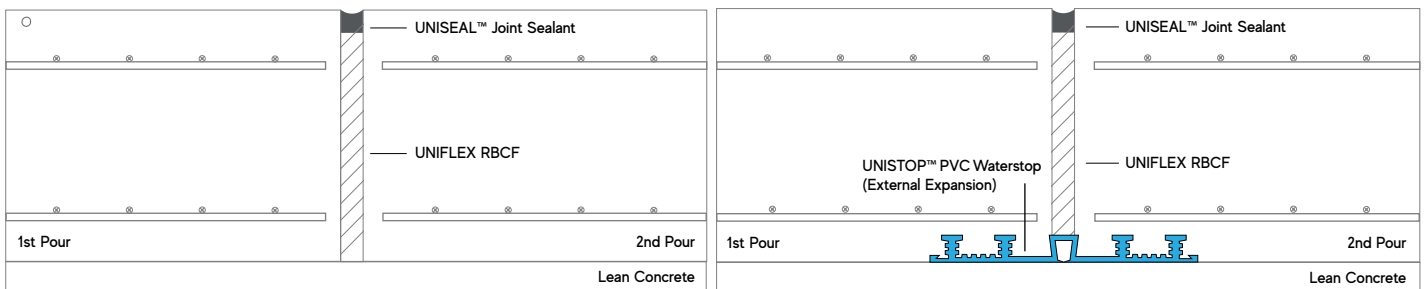

STANDARD DETAILS OF SLAB ON GROUND APPLICATIONS

INSTALLATION PROCEDURES

PREPARATION

To form an expansion joints in new concrete, brickwork, blockwork, and masonry, firstly construct one side of the joint prior to fixing **UNIFLEX RBCF**

NEW EXPANSION JOINT

A joint sealing slot can be formed by placing a removable timber former on top of the **UNIFLEX RBCF**.

Alternatively, **UNIFLEX RBCF** can be installed to the full depth of the slab and cut back to the required depth subsequently using a power brush machine. This latter method is generally used for housing estate roads which cannot be cleaned and sealed until all building has finished. Therefore, sealant wastage can be reduced.

UNISTICK™ CA contact adhesive can be used to spot bond the **UNIFLEX RBCF** in place, allow the contact adhesive to set before constructing the other side of the joint.

JOINT SEALING

After the sealing slot has been created, sealing the joint with an appropriate sealant from the **UNISEAL™** range. As sealants will not bond to **UNIFLEX RBCF** the additional need for bond breaker strips is eliminated.

HEALTH AND SAFETY

There are no health hazards associated with Fiberboard in normal use. As with all organic materials there is a very slight risk of spontaneous combustion if stored long term in wet conditions.

Store under cover in the dry. For further information on refer to the Material Safety Data sheet.

This technical data sheet is given in good faith and does not guarantee the application work. All Unity Reliance technical data sheets & method statements are updated on a regular basis and can be subject to change without notice. It is the users responsibility to obtain the latest version of the information required.



UNITY RELIANCE (M) SDN BHD

6-2, Jalan Meranti SD13/5, Bandar Sri Damansara
52200 Petaling Jaya Selangor.

Website : <https://www.unityreliance.com>
Email : unityreliance88@gmail.com
Tel : 03 - 6263 0139 / 010 - 785 1159